

# AUTO PRESSURE AIR TANK

---

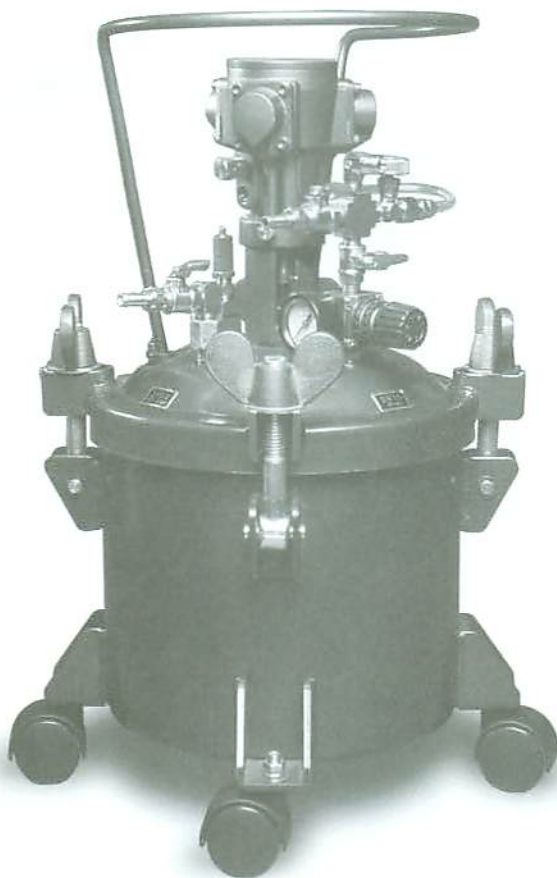

10A

# SCHEMATIC DRAWING

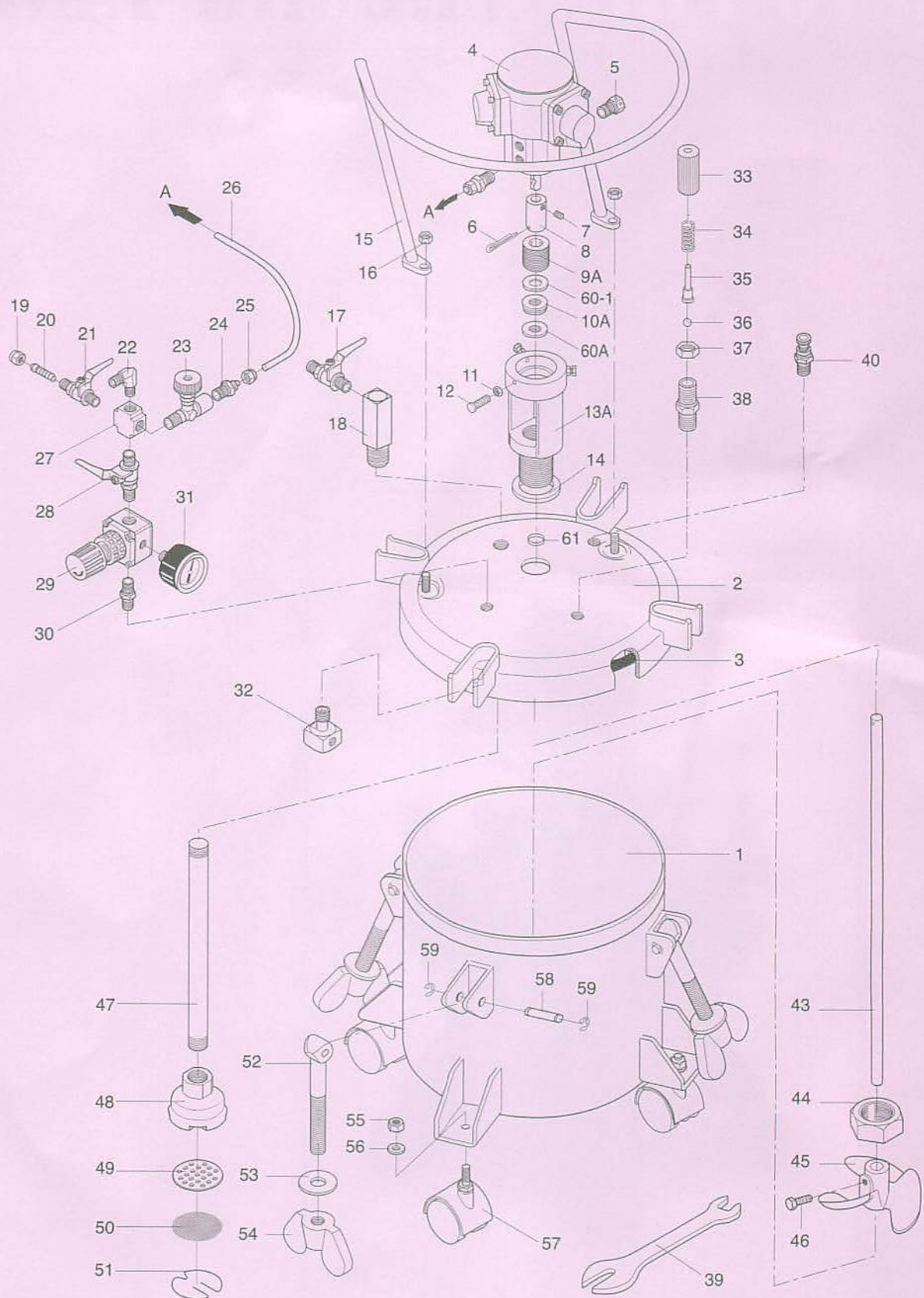



ITME NO:	DESCRIPTION	Q'ty
1	Material tank	1
2	Lid assembly	1
3	Gasket	1
4	Air motor	1
5	Silencer	1
6	Cotter pin	1
7	Set screw	2
8	Connecting bush	1
9A	Centering guide	1
10A	Seal-ring	3
11	Hexagon nut	3
12	Screw bolt	3
13A	Motor base	1
14	Seal ring	1
15	Parts guard	1
16	Hexagon nut	2
17	Palnt outlet cock	1
18	Material outlet adapter	1
19	Nut	1
20	Air outlet	1
21	Air outcock	1
22	Elbow(Air inlet)	1
23	Air valve	1
24	Adapter	2
25	Nut	2
26	Air hose	1
27	Branch four	1
28	Air inlet cock	1
29	Pressure regulator	1
30	Adapter	1
31	Pressure gauge	1

ITME NO:	DESCRIPTION	Q'ty
32	Air flow guider	1
33	Safety valve shell	1
34	Spring	1
35	Needle rod	1
36	Steel ball	1
37	Hexagon nut	1
38	Adapter	1
39	Spanner	1
40	Release valve	1
43	Agitating rod	1
44	Hexagon nut	1
45	Agitating propeller	1
46	Screw bolt	1
47	Fluid tube	1
48	Absorption apparatus	1
49	Filter base	1
50	Material filter	1
51	Snap ring	1
52	Swing bolt	4
53	Washer	4
54	Thumb nut	4
55	Nut	4
56	Washer	4
57	Wheel	4
58	Cotter pin	4
59	C-snap ring	8
60A	Seal-ring	1
60-1	Seal-ring	1
61	O-ring	2

## GENERAL INTRODUCTION

This pressure air tank is equipped with an air motor, air pressure regulator, safety valve, release cock, material outlet, inner material tank and 4 moving wheels.

For its durability, all the component parts are made with the finest materials and were strictly inspected before assembly. The surface of the whole tank were also treated with special paint to carry out a durable and cheerful appearance.

The material being sprayed can be agitated automatically by the air motor. That keeps the material smooth all the time during spraying and prevents the target product from color difference caused by material settling.

The capacity of this versatile tank enables the operator to carry out almost any job with professional results. What's more, special materials such as enamel paint, chemical liquid, glue, fluid food, sticky material...etc can also be transported as smoothly as required.

## CAUTION

For the sake of performing perfectly all the time. Thoroughly cleaning is advised to execute right after every spraying. That ensures not only to *reduce the* necessity for spare parts and also to prolong the life-span of the tank.

## WARNING

1.This pressure tank is only allowed to provide material pressurized up to maximum load of **80 PSI**.

Exceed this allowable load will result in explosion!

2.The safety valve is designed to protect the tank from over pressurization. The original valve of it is set as 60 PSI.

Make sure not to adjust it if not necessary indeed.

3.Do not make drilling, welding or other form of machining to any part of the tank.

Because the tampering caused by those in-proper preforming will weaken the structure.



# OPERATING

Check and make sure there is no pressured air remained in the tank before using. If there is, release it by turning release cock clock-wise until pressure bleeds down to Zero.

- 1 Loosen all thumb nuts and swing bolts, then remove the lid assembly away from the main tank.
- 2 Pour the material being sprayed into the material tank.
- 3 Replace the lid assembly and tighten it with main tank securely.
- 4 Connect the air supply hose to the air inlet.

Suggestion: It's better to add an air filter between this hose and the air inlet. For it can purify the air from dirt and entrained water or oil, which are not good to the material being sprayed.

- 5 Connect the atomizing air hose to the air outlet cock.
- 6 Turn on the air valve clock-wise to gain a proper speed for the air motor to agitate the material.
- 7 Connect the material hose to the material outlet cock.
- 8 Turn on the air supply, then turn air pressure regulator clock-wise to gain proper working pressure.

Make sure not to adjust it over 80 PSI!

- 9 Turn on air outlet cock.
- 10 Turn on material outlet cock.
- 11 Atomizing air for the spray gun can be adjusted at the gun by means of turning an adjusting valve on it.

Or, adding an air regulator kit to the tank can be the same.

- 12 Operate your spray gun according to the instructions attached with it.

## CLEANING AND MAINTENANCE

Thorough cleaning performed right after operating is always necessary. That reduce the necessity for spare parts and also prolong the durability of the tank. The process to do that is:

- 1 Turn air inlet cock off.
- 2 Turn on material cock.
- 3 Release all pressur eair remains in the tank.
- 4 Loosen all thumb nuts and swing bolts, then move the lid assembly to one side of the tank.
- 5 Loosen air cap retaining ring on spray gun about 3 turns.
- 6 Cup cloth over air cap on the gun, then pull trigger. This will force material back into the tank.
- 7 Empty the material tank. Then take some proper solvent to clean all the tank and the other parts which contact with material.
- 8 Pour clean solvent into the tank.
- 9 Replace the lid assembly back and tighten all the thumb nuts.
- 10 Turn air inlet cock on.
- 11 Operate the spray gun until clean solvent appears.
- 12 Repeat steps 1-6 in order to force solvent back to the tank.

## TROUBLE SHOOTING

PROBLEM	CAUSE	REMEDY
Indicator on air pressure gauge is out of function	Broken or damaged	Replace!
Material settles during operating	Not enough agitation for the material or the agitating propeller may be loosen or the air motor may be malfunctioner	Increase agitating or tighten it or check and replace part involved
Material or air leak out from lid gasket	Lid gasket has worn off or thumb nuts were not tightened enough	Replace it or tighten then
Air leak out from release cock after being screwed	The O-ring in it may be damaged	Replace it
Material does not come out smoothky	Filter or Fluid tube may be stock	Check and clean it

Note: Check pressure gauge occasionally. The indicator should indicate to zero whenever there is no pressure in the tank.



# AUTO PRESSURE AIR TANK

